

FLAVIA C600 Cleaning Procedures

Daily Care:

EMPTYING AND CLEANING THE DRIP TRAY

The drip tray is a 3-piece design with the lower part used to collect spillages or overflows. If the drip tray is full, spillages will leak from the highlighted area in the next section. To avoid overflow, please check the drip tray regularly.

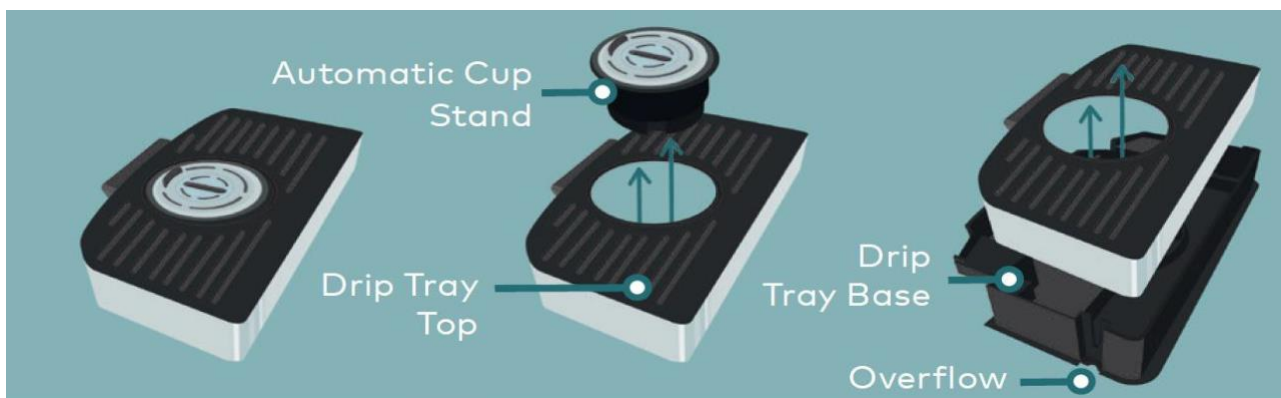

1. Lift out and empty drip tray. **CAUTION - CONTENTS MAY BE HOT.**
2. Lift out the cup stand.
3. Separate the remaining top and bottom parts of the tray.
4. Hand wash the drip tray top, and cup stand rings.
5. Wash the remaining parts in the dishwasher. Alternatively, clean them in warm, soapy water. Wipe the area underneath and around the drip tray.
6. Reassemble the top and bottom halves of the drip tray. Drop in the adjustable cup stand ensuring it is in its lowest position. Do not force it flat. If the stand is raised, please see the instructions below as to how the lowest cup stand position is reset.
7. Once reassembled, drop the drip tray back into the base of the brewer and push it gently towards the brewer. Magnets will help lock it in place. The cup stand will automatically be lifted up and down. The brewer will then be ready to vend drinks again.

Question? Contact:

AAA Business Supplies & Interiors

To Order Supplies: shop.aaasolutions.com | order@aaasolutions.com | 800.821.4430 **For Service:** service@aaasolutions.com

Daily Care Continued...

RESETTING THE CUP STAND TO ITS LOWEST POSITION AFTER CLEANING

After disassembly of the drip tray, the cup stand may occasionally become extended. Do not force it flat into its lower position, as doing so may damage the part. To return the cup stand to its lowest position, simply follow the steps below:

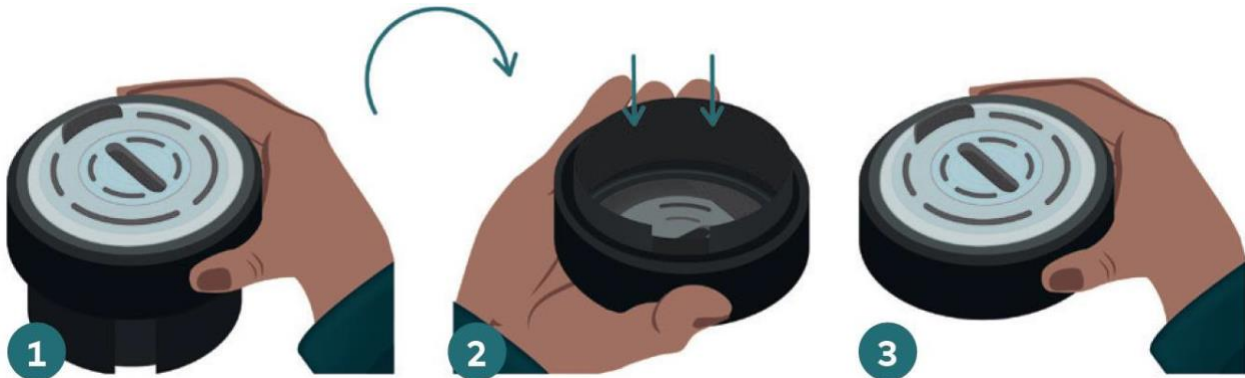

1. Hold the outer part of the cup stand and turn it upside down.
2. The inner part should then slide inside on its own.
3. Turn the cup stand right side up again to keep the stand in its lowest state.

RE-ASSEMBLING THE CUP STAND

In order to prevent permanent damage to the cup stand when dropped, it has been designed to come apart and can be re-assembled by following the below steps:

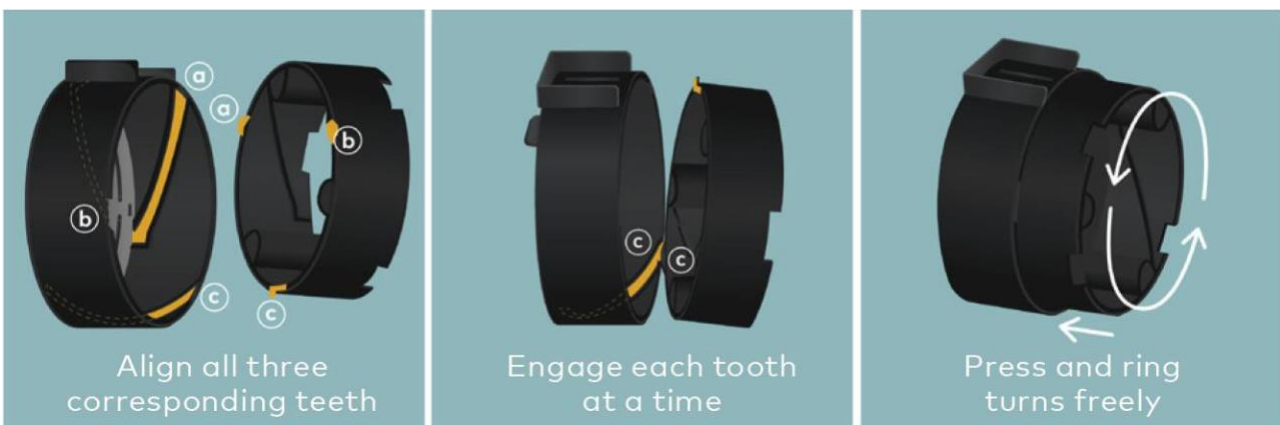

Question? Contact:

AAA Business Supplies & Interiors

To Order Supplies: shop.aaasolutions.com | order@aaasolutions.com | 800.821.4430 For Service: service@aaasolutions.com

Daily Care Continued...

EMPTYING THE FRESHPACK BIN

If the brewer is used with an internal Freshpack bin rather than the funnel, it should be emptied and cleaned when full. Follow instructions on the screen or below to empty the bin once the maximum number of allowable packs has been vended. Animations will indicate the process. Since removing the bin resets the bin counter, ensure to always empty the bin and not put it back partly full.

1. Remove the drip tray.
2. Pull bin towards you and empty the bin using a suitable receptacle.
3. Clean front of bin and inside bin with warm, soapy water.
4. Return bin to its original position in the brewer.
5. Return the drip tray to its original position.



CLEANING THE CUP DETECTION SENSORS

In order to guarantee a great user experience and avoid the cups not being recognized, please make sure to clean the cup sensors and ensure they are dry and free of streaks:

1. Remove Freshpack door to access air duct.
2. Clean cup sensors and air ducts.
3. After cleaning, sanitize surfaces with a non-chlorine based anti-bacterial wipe or solution. Avoid scented products, as they will affect drink taste.

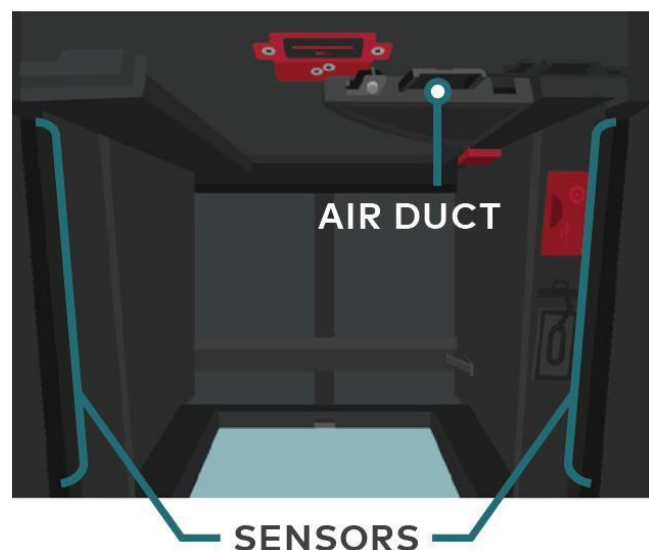

Question? Contact:

AAA Business Supplies & Interiors

To Order Supplies: shop.aaasolutions.com | order@aaasolutions.com | 800.821.4430 **For Service:** service@aaasolutions.com

Weekly Care:

Use a clean damp cloth to wipe the outside surfaces and exposed areas inside. Do not use strong detergents as they may damage or tarnish the finish of the brewer. If spillage occurs, please perform this cleaning method immediately to prevent potential product taste cross contamination or allergen transfer.

REMOVING AND CLEANING THE FRESHPACK DOOR

1. Select the "TOUCH TO INSERT PACK" button from the main menu and the Freshpack door will open. On the left side of the door, there is a red lever. Move the lever down to release the door to its horizontal position on the hinge.



2. Once the Freshpack door is in a horizontal position, it should be parallel to the counter. Pull the door out towards you while keeping it parallel to the counter to release it from the brewer.

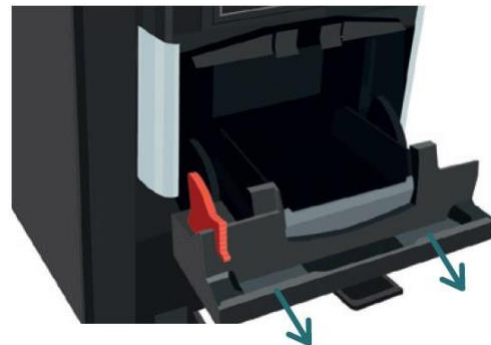

3. Wash in warm soapy water and rinse thoroughly. Wipe the sides of the area where door was within the brewer. Also, wipe down insides of chassis to remove residue. Do not wash the Freshpack door in the dishwasher to prevent damage.
4. Put the door back into the brewer by completing step 2 in reverse.
5. Push the door to fully close it and replace the Freshpack bin and drip tray if they were removed in step 1 as the brewer was out of power.
6. Dispense 1 cup of hot water through the system to provide a final rinse and discard.

Question? Contact:

AAA Business Supplies & Interiors

To Order Supplies: shop.aaasolutions.com | order@aaasolutions.com | 800.821.4430 **For Service:** service@aaasolutions.com

Weekly Care Continued...

CLEANING THE BARCODE SCANNER

On the rare occurrence that the barcode scanner becomes dirty and doesn't scan Freshpacks, it will need to be cleaned. To test whether the barcode is being read, press "TOUCH TO INSERT PACK". Insert a Freshpack (e.g., Hot Chocolate or Real Milk Froth). If the next screen does not show a shortlist of compatible drinks, the scanner has not read the pack.

1. Access the barcode scanner by removing the drip tray, Freshpack bin, and the Freshpack door. The barcode scanner is located inside the brewer, at the top, towards the back of the brewer.
2. Clean the barcode scanner with a clean, moist, lint-free cloth or lens cleaner cloth. For best results, dry any moisture from the lens after cleaning to prevent streaks from being left behind.

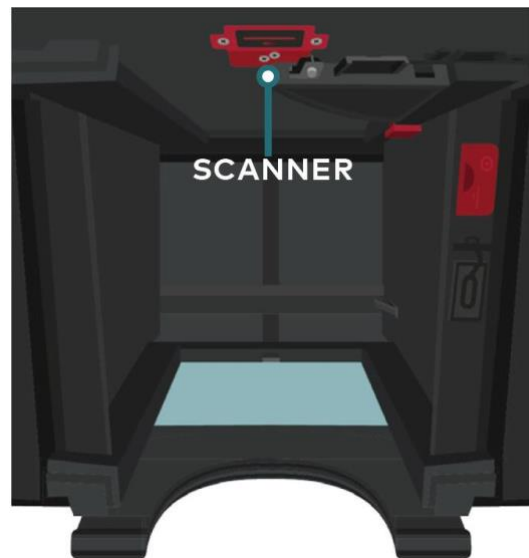

Question? Contact:

AAA Business Supplies & Interiors

To Order Supplies: shop.aaasolutions.com | order@aaasolutions.com | 800.821.4430 **For Service:** service@aaasolutions.com